



DEPARTMENT OF AGRICULTURE

CARAGA REGION
CAPITOL SITE, BUTUAN CITY

CONSTRUCTION OF UV PLASTIC SHED

RTR, Agusan del Norte
Sison, Surigao del Norte



Republic of the Philippines
 DEPARTMENT OF AGRICULTURE
 Central Region
 Cagayan Region
 Cagayan City
 Tel. No. (0951) 342-0791; Telefax No. (0951) 341-2114

Project Name: Construction of UV Plastic Shed
 Location: RTR, AOSM, Sison, SDN
 Implementing Agency: IADDA-Cagayan Region
 Development Partner:
 Contractor: Supplier
 Brief Description:

Project Details

Project Date	Project Status	Remarks	Date of Completion
Duration	Start	Target	Percentage of
		at/After	Insurance
		Completion	to Date
28 C.D.			

For particulars or comments about this project, please contact Regional Office or Cluster which has valid jurisdiction on this project.

COA Regional Office No. Cagayan, MIMICARAGA
 Address: SOUTHERN MONTILLA BOULEVARD, BUTUAN CITY
 Contact No. (0851) 342-5565 or fax: COA Cluster 1, Butuan at (0915) 5391097

FONT COLOR : BLACK
 FONT RESOLUTION : 70dpi
 FONT : HELVETICA
 FONT SIZE : MAIN INFORMATION : 1"
 SUB-INCREMENTATION : 1"

PROJECT BILLBOARD DETAILS
 NOT TO SCALE

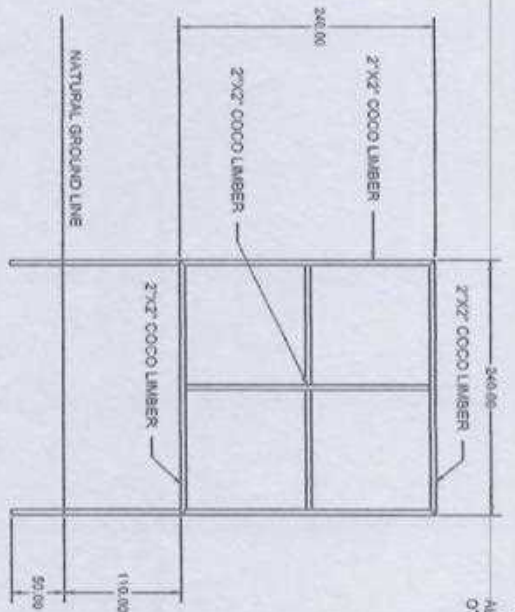

FRAMING DETAILS
 SCALE: 1:50
 MTS.

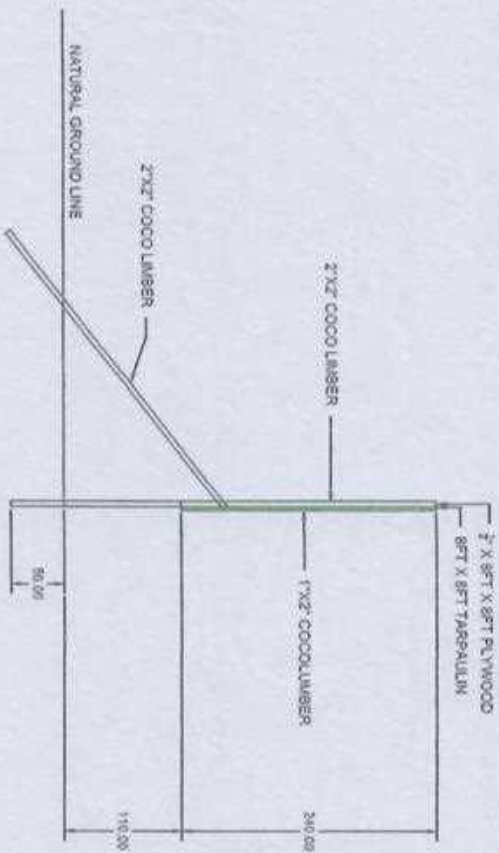

LEFT & RIGHT SIDE ELEVATION
 SCALE: 1:50
 MTS.

NOTE:
 ALL DIMENSIONS ARE IN CENTIMETERS UNLESS OTHERWISE SPECIFIED

Republic of the Philippines DEPARTMENT OF AGRICULTURE RFO XIII, Capitol Sta., Butuan City	Project Title: Construction of UV Plastic Shed	Prepared by: ENGR. RAFAEL S. MEDOS ENGINEER	Checked & Reviewed by: ENGR. THRESSA LYN B. LIMAS ENGINEER III	Submitted by: ENGR. RAFAEL S. MEDOS ENGINEER	Noted by: JACINTO M. BUSTARDO Senior Development Officer Div.	Recommended by: RESERVOIR M. ALIBES RTO (Operations)	Approved by: ENGR. RICARDO M. OÑATE, JR. Regional Executive Director	Sheet Content: Project Billboard/Signboard	Sheet No. 1 of 4
-------------------------------------------------------------------------------------------------	---------------------------------------------------	---------------------------------------------------	----------------------------------------------------------------------	----------------------------------------------------	---------------------------------------------------------------------	------------------------------------------------------------	----------------------------------------------------------------------------	-----------------------------------------------	---------------------

NOTE:
ALL DIMENSIONS ARE IN CENTIMETERS UNLESS OTHERWISE SPECIFIED

ALL CONNECTIONS SHALL BE FULL WELDED

38 MM Ø G.I. PIPE, SCHEDULE 40

NOTE:
USE 38MM Ø G.I. PIPE, SCHEDULE 40 FOR ABACA HANGER SPACED AT 21, 43 CENTIMETER ON CENTER

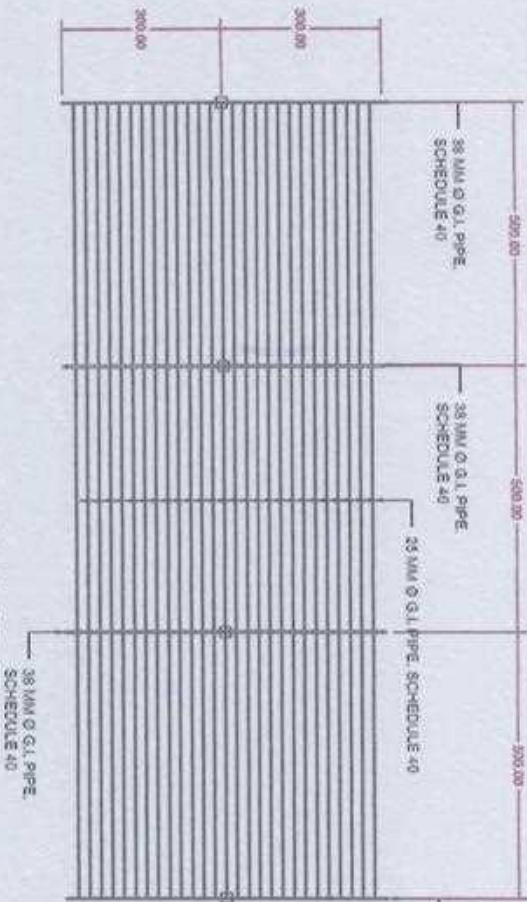

DETAILS OF ABACA HANGER
SCALE: 1:100 MTS.

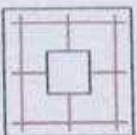
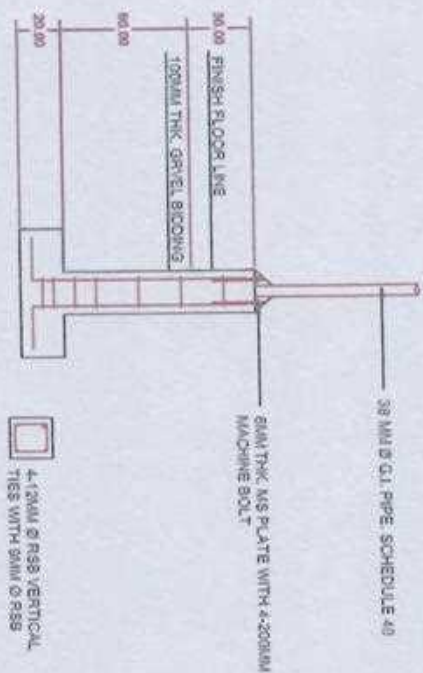

6-13MM Ø RSS MATTING

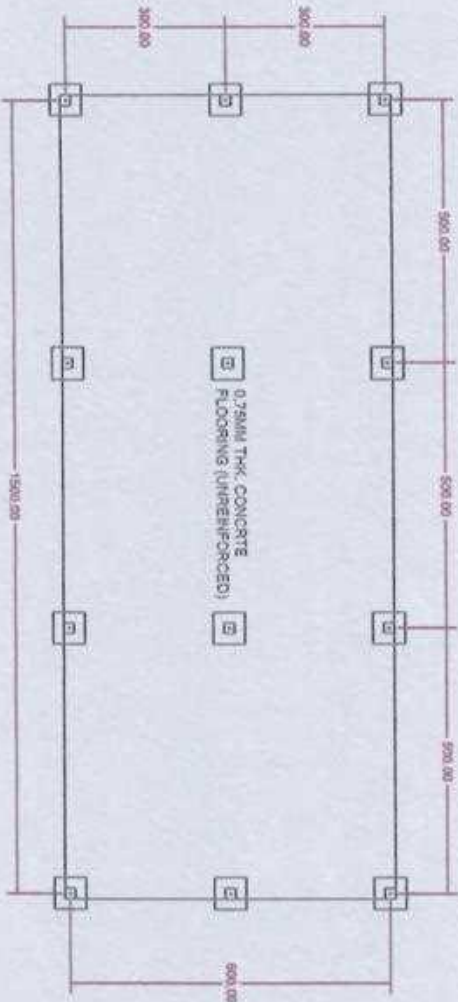

FLOOR PLAN
SCALE: 1:100 MTS.

Republic of the Philippines DEPARTMENT OF AGRICULTURE RFO XII, Central Sta. Bldg. City	Project Title Construction of UV Plastic Shed	Prepared by: ENGR. RICHARD S. MELOS ENCL. 10/28/11	Checked & Reviewed by: ENGR. JESSALYN B. LIMAS ENCL. 11/01/11	Submitted by: ENGR. JESSE D. VILLANUEVA CHIEF, RFO XII	Noted by: MS. SCOT H. QUINLAN Chief, Operations Div.	Recommended by: REBECCA R. VILSA RFO XII Supervisor	Approved by: ENGR. RICHARD S. MELOS Regional Executive Director	Sheet Content: Floor Plan F1C1 Det. Details of Abaca Hanger	Sheet No. 2 4
----------------------------------------------------------------------------------------------	--------------------------------------------------	----------------------------------------------------------	---------------------------------------------------------------------	--------------------------------------------------------------	------------------------------------------------------------	-----------------------------------------------------------	-----------------------------------------------------------------------	----------------------------------------------------------------------	---------------------

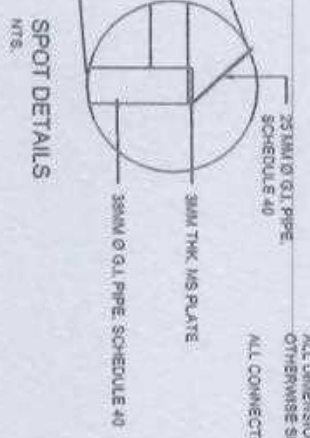
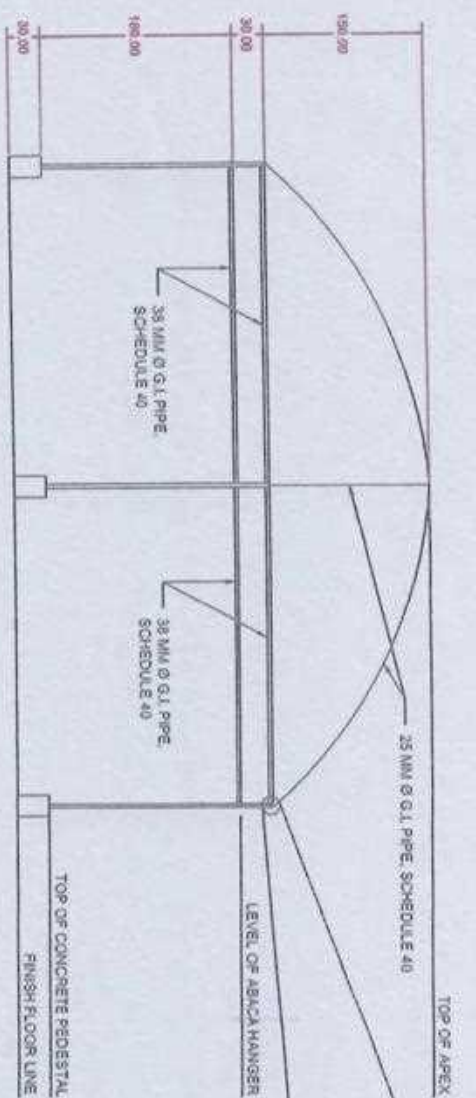

NOTE:
 ALL DIMENSIONS ARE IN CENTIMETERS UNLESS OTHERWISE SPECIFIED
 ALL CONNECTIONS SHALL BE FULL WELDED

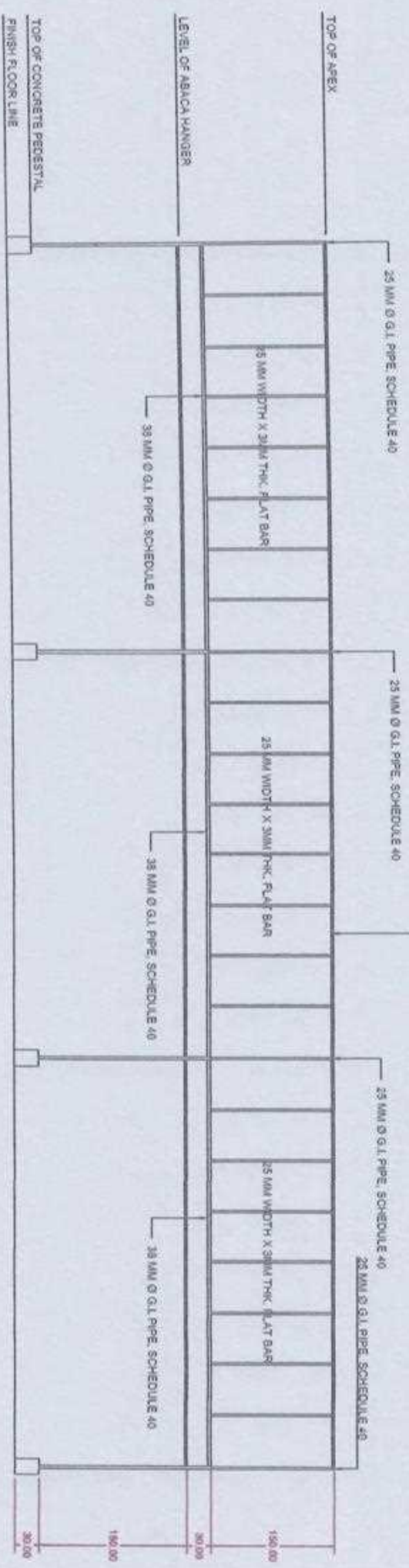

STEEL FRAMING DETAILS
 SCALE: 1:50
 N.T.S.

25 MM WIDTH X 3MM THK. FLAT BAR

Republic of the Philippines DEPARTMENT OF AGRICULTURE PPO VIII, Capitol Site, Bulacan City	Project Title Construction of UV Plastic Shed	Prepared by ENGR. JAMES S. MEJOS ENGINEER II	Checked & Reviewed by ENGR. JESSICA LYNN B. LIMAS ENGINEER III	Submitted by ENGR. JESSICA LYNN B. LIMAS ENGINEER III	Noted by MS. JESSICA LYNN B. LIMAS Chief, Field Operations Div.	Recommended by RESERVAIR ATENGO RTD for Operations I	Approved by ENGR. CARDO W. ONATE, JR. Regional Executive Director	Sheet Content Steel Framing Details	Sheet No. 3 4
--------------------------------------------------------------------------------------------------	--------------------------------------------------	----------------------------------------------------	----------------------------------------------------------------------	-------------------------------------------------------------	-----------------------------------------------------------------------	------------------------------------------------------------	-------------------------------------------------------------------------	----------------------------------------	---------------------

NOTE:
ALL DIMENSIONS ARE IN CENTIMETERS UNLESS OTHERWISE SPECIFIED

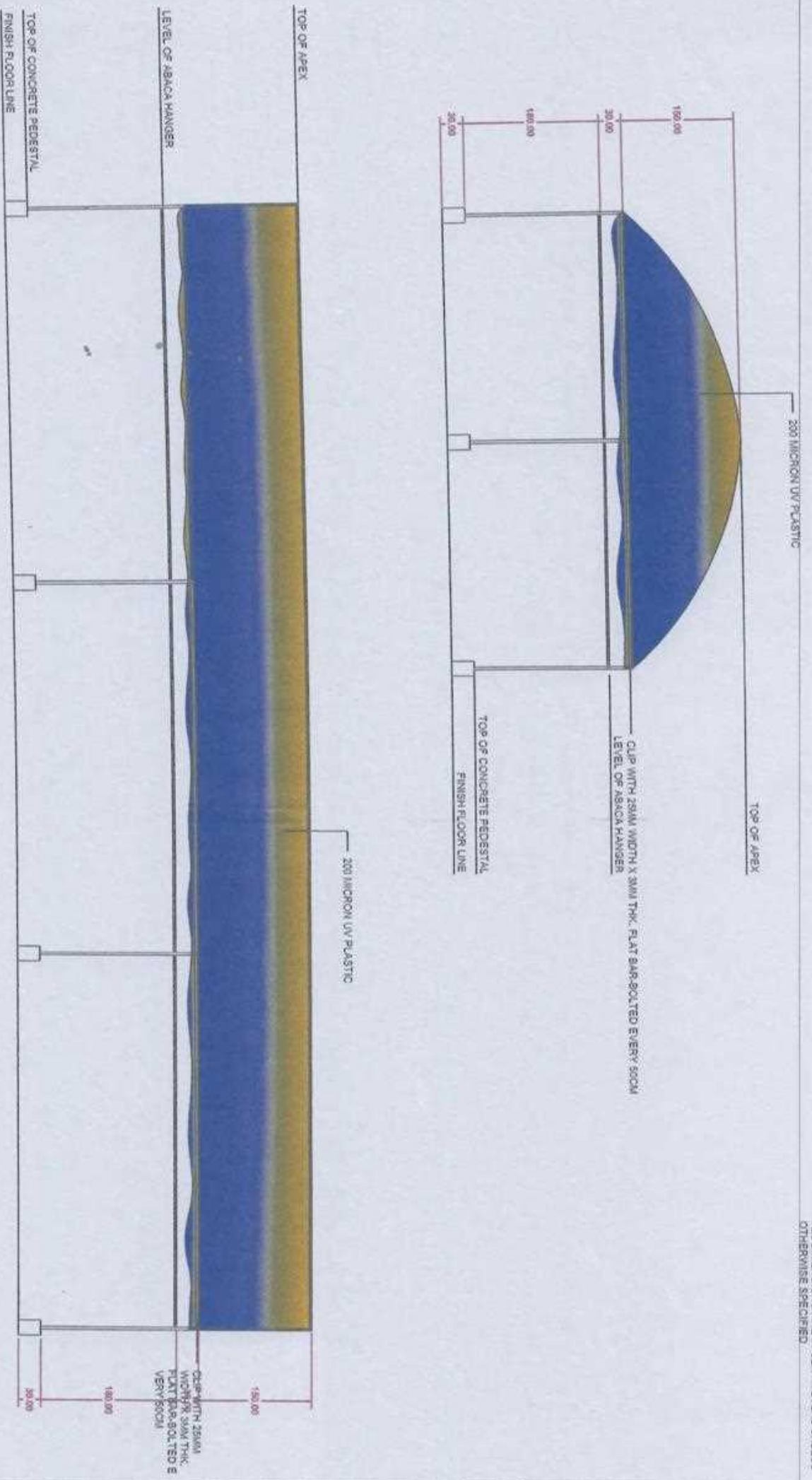

Republic of the Philippines DEPARTMENT OF AGRICULTURE RPO XIII, Capital Sta., Buluan City	Project Title Construction of UV Plastic Shed	Prepared by ENGR. JOSE S. MEDIOS ENGR. # 10188	Checked & Reviewed by ENGR. DISSA LYN B. LIMAS ENGINEER III	Submitted by ENGR. JEFF O. MORALES ENGINEER	Noted by MR. [Signature] Special Executive Director	Recommended by RESERVOIR DIV. RFD for Operation	Approved by ENGR. CARDO M. ORATE, JR. Special Executive Director	Sheet Content UV Shed Det.	Sheet No. 4
-------------------------------------------------------------------------------------------------	--------------------------------------------------	------------------------------------------------------	-------------------------------------------------------------------	---------------------------------------------------	-----------------------------------------------------------	-------------------------------------------------------	------------------------------------------------------------------------	-------------------------------	----------------