



Republic of the Philippines
DEPARTMENT OF AGRICULTURE
 Caraga Region

Capitol Site, Butuan City
 Tel. No: (085) 815-2009/ (085)342-4092/Fax No.: (085) 341-2114
 Email add: dacaraga@yahoo.com

REQUEST FOR QUOTATION

Date: _____
 Quotation #: _____

Name of Company _____

Address _____

TIN No. _____

Please quote your lowest price inclusive of taxes in the items/s listed, subject to the General Conditions below, stating the shortest time of delivery. Submit your quotation duly signed by your representative not later than **Philgeps** in sealed envelope marked with the reference no. (PR # 24-11-16D184).

ABEL F. MAGAS 3 DEC 2024
 Chairman, Bids and Awards Committee

Item No.	ITEM AND DESCRIPTION	Brand/ Model	Unit	Quantity	Unit Cost	Total Cost
1	IMPROVEMENT OF REGIONAL SOIL TESTING LABORATORY BUILDING		contract	1		
	<i>Please refer to attached Program of Works</i>					
	-XXXXXXXXXXXXXXXXXXXXXXXXXX-					

ABC: ₱265,000.00
 Source of Fund: ILD/RSL

General Conditions:

- All entries must be typewritten/printed in ink.
- Delivery period within _____ calendar days based on the contract.
- Warranty shall be for a period of six (6) months for supplies & materials, one (1) year for equipment from date of acceptance by procuring entity.
- Price validity shall be for a period of _____ calendar days
- PhilGEPS Registration Certificate, Business Permit, DTI Certificate and Tax Registration Certificate shall be attached upon submission of the quotation, if applicable.
- Bidders shall submit original brochures showing specification of the products being offered.
- Winning bidder(s) from outside Butuan City must appear personally or sent authorized representative to signed contract and claimed payments.

After having carefully read and accepted your General Conditions, I/We quote on the item at prices noted above.

Printed Name/Signature of Company Representative _____

Name and Signature of Convasser _____

Tel.No./Cp No./email address _____

Date _____



VICINITY MAP

BILL OF QUANTITIES

ITEM NO.	DESCRIPTION	QUANTITY	UNIT
1.1	REMOVE REINFORCED CONCRETE	1.000	CU M
1.2	REMOVE STRUCTURAL STEEL	1.000	KG
1.3	REMOVE CONCRETE	1.000	CU M
1.4	REMOVE REINFORCED STEEL	1.000	KG
1.5	REMOVE CONCRETE	1.000	CU M
1.6	REMOVE REINFORCED STEEL	1.000	KG
1.7	REMOVE CONCRETE	1.000	CU M
1.8	REMOVE REINFORCED STEEL	1.000	KG
1.9	REMOVE CONCRETE	1.000	CU M
1.10	REMOVE REINFORCED STEEL	1.000	KG
1.11	REMOVE CONCRETE	1.000	CU M
1.12	REMOVE REINFORCED STEEL	1.000	KG
1.13	REMOVE CONCRETE	1.000	CU M
1.14	REMOVE REINFORCED STEEL	1.000	KG
1.15	REMOVE CONCRETE	1.000	CU M
1.16	REMOVE REINFORCED STEEL	1.000	KG
1.17	REMOVE CONCRETE	1.000	CU M
1.18	REMOVE REINFORCED STEEL	1.000	KG
1.19	REMOVE CONCRETE	1.000	CU M
1.20	REMOVE REINFORCED STEEL	1.000	KG
1.21	REMOVE CONCRETE	1.000	CU M
1.22	REMOVE REINFORCED STEEL	1.000	KG
1.23	REMOVE CONCRETE	1.000	CU M
1.24	REMOVE REINFORCED STEEL	1.000	KG
1.25	REMOVE CONCRETE	1.000	CU M
1.26	REMOVE REINFORCED STEEL	1.000	KG
1.27	REMOVE CONCRETE	1.000	CU M
1.28	REMOVE REINFORCED STEEL	1.000	KG
1.29	REMOVE CONCRETE	1.000	CU M
1.30	REMOVE REINFORCED STEEL	1.000	KG
1.31	REMOVE CONCRETE	1.000	CU M
1.32	REMOVE REINFORCED STEEL	1.000	KG
1.33	REMOVE CONCRETE	1.000	CU M
1.34	REMOVE REINFORCED STEEL	1.000	KG
1.35	REMOVE CONCRETE	1.000	CU M
1.36	REMOVE REINFORCED STEEL	1.000	KG
1.37	REMOVE CONCRETE	1.000	CU M
1.38	REMOVE REINFORCED STEEL	1.000	KG
1.39	REMOVE CONCRETE	1.000	CU M
1.40	REMOVE REINFORCED STEEL	1.000	KG
1.41	REMOVE CONCRETE	1.000	CU M
1.42	REMOVE REINFORCED STEEL	1.000	KG
1.43	REMOVE CONCRETE	1.000	CU M
1.44	REMOVE REINFORCED STEEL	1.000	KG
1.45	REMOVE CONCRETE	1.000	CU M
1.46	REMOVE REINFORCED STEEL	1.000	KG
1.47	REMOVE CONCRETE	1.000	CU M
1.48	REMOVE REINFORCED STEEL	1.000	KG
1.49	REMOVE CONCRETE	1.000	CU M
1.50	REMOVE REINFORCED STEEL	1.000	KG

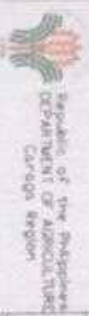

Department of the Philippines
DEPARTMENT OF AGRICULTURE
Caraga Region

PROJECT TITLE
IMPROVEMENT OF REGIONAL
SOIL TESTING LABORATORY
BUILDING

PREPARED BY
JAMES R. LUNA, JR. PE/MSCE
ENGINEER

CHECKED & REVISED BY
JESSE A. LUNA, JR. PE/MSCE
ENGINEER

DESIGNED BY
JAMES R. LUNA, JR. PE/MSCE
ENGINEER

RECOMMENDING APPROVAL
JESSE A. LUNA, JR. PE/MSCE
ENGINEER

APPROVED BY
JAMES R. LUNA, JR. PE/MSCE
ENGINEER

SHEET CONTAINS
VICINITY MAP
BILL BOARD DETAILS
BILL OF QUANTITIES
SPECIFICATIONS

SHEET NO.
1
2

GENERAL NOTES AND SPECIFICATIONS

- THE IMPROVEMENT OF SOIL TESTING LABORATORY BUILDING INCLUDES REMOVAL OF STRUCTURES AND DESTROYING GENERAL LITER ADDRESS.
- THE IMPROVEMENT OF SOIL TESTING LABORATORY BUILDING INCLUDES PAINTING WORK.
- THE MINIMUM COMPRESSIVE STRENGTH OF CONCRETE AT 28 DAYS MUST BE EQUAL TO 20,000 MPa/29,000 PSI.
- THE MINIMUM YIELD STRENGTH OF REINFORCING STEEL MUST BE EQUAL TO 275.80 MPa/40,000 PSI ALL STRUCTURAL METALS SHALL BE PAINTED WITH ANTI-CORROSION PAINT.
- THE MINIMUM YIELD STRENGTH OF STRUCTURAL STEEL MUST BE EQUAL TO 235 MPa/34,000 PSI.
- LAP SPACE ON REINFORCING STEEL INSTALLATION MUST BE NOT LESS THAN 50 CM.
- ALL INSTALLATION SHALL BE DONE IN WORKMANLIKE MANNER AND SHALL INCLUDE ALL NECESSARY WORKS THAT MAY NOT CLEARLY INDICATED IN THE PLANS OR LAYOUT BUT NECESSARY TO ATTAIN THE PURPOSE AND BENEFIT OF THE DESIGN.
- ALL MATERIALS TO BE SUPPLIED SHALL BE NEW AND HIGHLY QUALITY SUITABLE FOR THE LOCATION PURPOSE. MATERIALS SHALL BE STANDARD PRODUCTS OF THE REPUTABLE MANUFACTURER.

BILLBOARD/SIGNAGE DET
SCALE 1:50
MTS

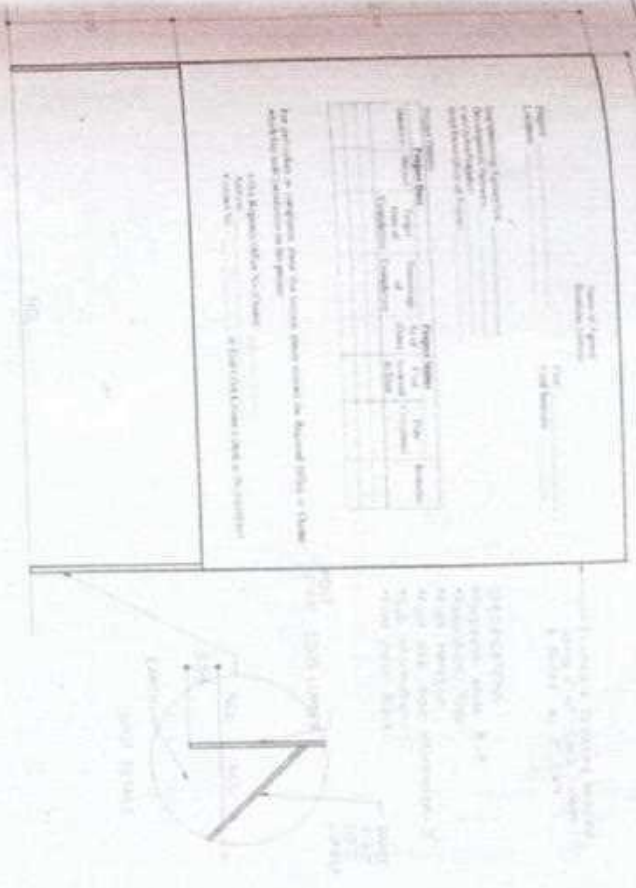

For particular information, please refer to the notes on the General Notes or Specifications.

Item No.	Description	Quantity	Unit	Remarks
1	Billboard/Signage	1	MTS	
2	Billboard/Signage	1	MTS	
3	Billboard/Signage	1	MTS	
4	Billboard/Signage	1	MTS	
5	Billboard/Signage	1	MTS	
6	Billboard/Signage	1	MTS	
7	Billboard/Signage	1	MTS	
8	Billboard/Signage	1	MTS	
9	Billboard/Signage	1	MTS	
10	Billboard/Signage	1	MTS	
11	Billboard/Signage	1	MTS	
12	Billboard/Signage	1	MTS	
13	Billboard/Signage	1	MTS	
14	Billboard/Signage	1	MTS	
15	Billboard/Signage	1	MTS	
16	Billboard/Signage	1	MTS	
17	Billboard/Signage	1	MTS	
18	Billboard/Signage	1	MTS	
19	Billboard/Signage	1	MTS	
20	Billboard/Signage	1	MTS	
21	Billboard/Signage	1	MTS	
22	Billboard/Signage	1	MTS	
23	Billboard/Signage	1	MTS	
24	Billboard/Signage	1	MTS	
25	Billboard/Signage	1	MTS	
26	Billboard/Signage	1	MTS	
27	Billboard/Signage	1	MTS	
28	Billboard/Signage	1	MTS	
29	Billboard/Signage	1	MTS	
30	Billboard/Signage	1	MTS	
31	Billboard/Signage	1	MTS	
32	Billboard/Signage	1	MTS	
33	Billboard/Signage	1	MTS	
34	Billboard/Signage	1	MTS	
35	Billboard/Signage	1	MTS	
36	Billboard/Signage	1	MTS	
37	Billboard/Signage	1	MTS	
38	Billboard/Signage	1	MTS	
39	Billboard/Signage	1	MTS	
40	Billboard/Signage	1	MTS	
41	Billboard/Signage	1	MTS	
42	Billboard/Signage	1	MTS	
43	Billboard/Signage	1	MTS	
44	Billboard/Signage	1	MTS	
45	Billboard/Signage	1	MTS	
46	Billboard/Signage	1	MTS	
47	Billboard/Signage	1	MTS	
48	Billboard/Signage	1	MTS	
49	Billboard/Signage	1	MTS	
50	Billboard/Signage	1	MTS	

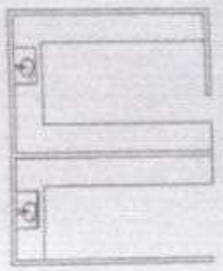

EXISTING FLOOR PLAN
SCALE 1:100
M.T.S.

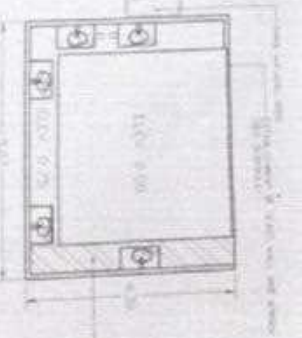

PROPOSED FLOOR PLAN
SCALE 1:100
M.T.S.

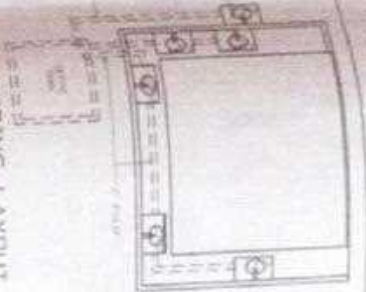

PLUMBING LAYOUT
SCALE 1:100
M.T.S.

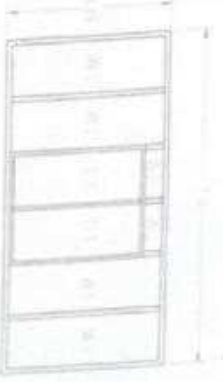

DOORS & WINDOW GLASS DET.
SCALE 1:50
M.T.S.

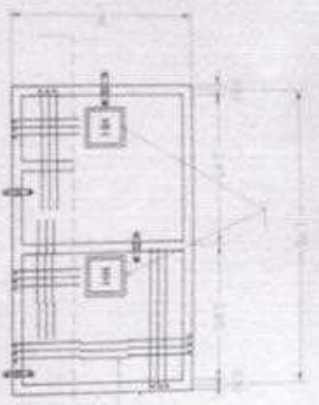

SEPTIC TANK PLAN
M.T.S.

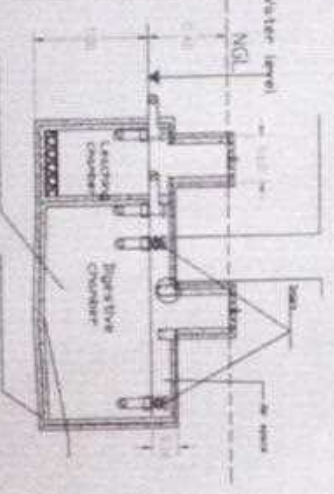

SEPTIC TANK SECTION
M.T.S.

PLUMBING NOTES:

- GRADE'S OF HORIZONTAL PIPING, SHALL BE MAINTAINED AS SHOWN ON THE DRAWING, UNLESS OTHERWISE SPECIFIED.
- GRADE'S OF HORIZONTAL PIPING, SHALL BE MAINTAINED AS SHOWN ON THE DRAWING, UNLESS OTHERWISE SPECIFIED.
- GRADE'S OF HORIZONTAL PIPING, SHALL BE MAINTAINED AS SHOWN ON THE DRAWING, UNLESS OTHERWISE SPECIFIED.
- GRADE'S OF HORIZONTAL PIPING, SHALL BE MAINTAINED AS SHOWN ON THE DRAWING, UNLESS OTHERWISE SPECIFIED.
- GRADE'S OF HORIZONTAL PIPING, SHALL BE MAINTAINED AS SHOWN ON THE DRAWING, UNLESS OTHERWISE SPECIFIED.
- GRADE'S OF HORIZONTAL PIPING, SHALL BE MAINTAINED AS SHOWN ON THE DRAWING, UNLESS OTHERWISE SPECIFIED.
- GRADE'S OF HORIZONTAL PIPING, SHALL BE MAINTAINED AS SHOWN ON THE DRAWING, UNLESS OTHERWISE SPECIFIED.
- GRADE'S OF HORIZONTAL PIPING, SHALL BE MAINTAINED AS SHOWN ON THE DRAWING, UNLESS OTHERWISE SPECIFIED.
- GRADE'S OF HORIZONTAL PIPING, SHALL BE MAINTAINED AS SHOWN ON THE DRAWING, UNLESS OTHERWISE SPECIFIED.
- GRADE'S OF HORIZONTAL PIPING, SHALL BE MAINTAINED AS SHOWN ON THE DRAWING, UNLESS OTHERWISE SPECIFIED.

DESIGN CRITERIA:

- Concrete Fc = 28,000 Mpa (3,000 psi), minimum compressive strength of concrete at 28 days.
- Rebar fy = 275,000 Mpa (40,000 psi), minimum yield strength of reinforcing bars.



TILE LAYOUT
SCALE 1:100
M.T.S.

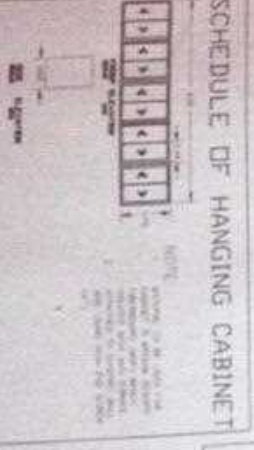

SCHEDULE OF HANGING CABINET

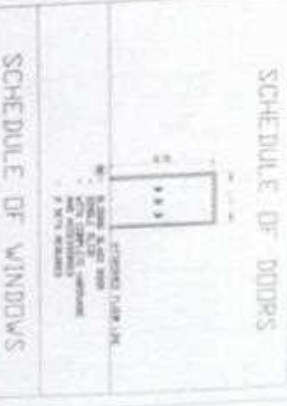

SCHEDULE OF DOORS

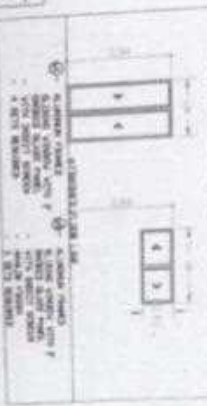

SCHEDULE OF WINDOWS

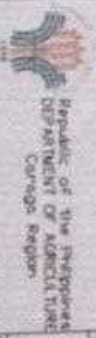

Ministry of Agriculture
Government of the Republic of Uganda
Cairo Region

APPROVED BY: [Signature]
PROJECT TITLE: IMPROVEMENT OF REGIONAL SOIL TESTING LABORATORY BUILDING
LOCATION: B.B. THABER, KILIMOTO, UGANDA

CHECKED & REVISED BY: [Signature]
DESIGNED BY: [Signature]

RECOMMENDING APPROVAL: [Signature]
PROJECT BY: [Signature]
SHEET CONTAINS: 45 DRAWINGS
SHEET NO.: 2